



NH2XLPV-C(D) 1500V DC 63A-400A

Photovoltaic Fuse

光伏熔断器



Standard/ 标准: IEC 60269-6, UL 248-19

INTERRUPTING CAPACITY/ 分断能力:
50,000 A at 1500V DC

Dimensions/ 尺寸:

Unit 单位: mm

Type:NH2XLPV-C Part No.: 2XLPV(amp rating)U15C/C2

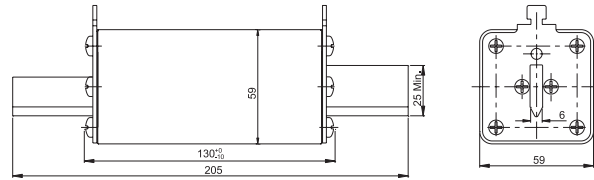

Type:NH2XLPV-D Part No.: 2XLPV(amp rating)U15D

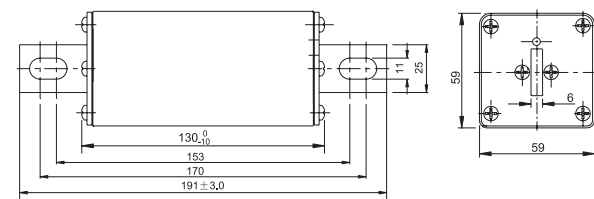

Type:NH2XLPV-D Part No.: 2XLPV(amp rating)U15DC

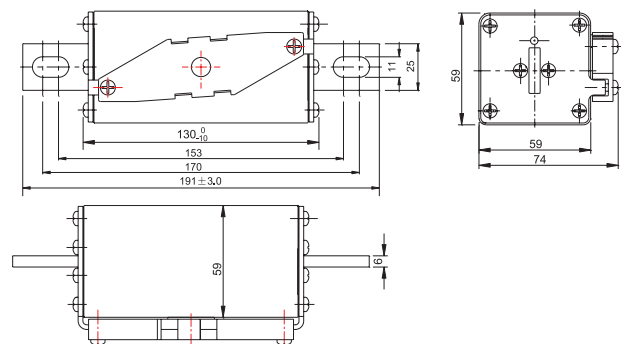

TECHNICAL PARAMETERS/ 技术参数:

PART NO. 目录编号	CURRENT RATING 额定电流	SAFETY APPROVALS 安全认证	
		cULus	TUV
2XLPV63U15C/C2	63A	○	●
2XLPV63U15D/DC		○	●
2XLPV80U15C/C2	80A	○	●
2XLPV80U15D/DC		○	●
2XLPV100U15C/C2	100A	○	●
2XLPV100U15D/DC		○	●
2XLPV125U15C/C2	125A	●	●
2XLPV125U15D/DC		●	●
2XLPV160U15C/C2	160A	●	●
2XLPV160U15D/DC		●	●
2XLPV200U15C/C2	200A	●	●
2XLPV200U15D/DC		●	●
2XLPV250U15C/C2	250A	●	●
2XLPV250U15D/DC		●	●
2XLPV315U15C/C2	315A	●	●
2XLPV315U15D/DC		●	●
2XLPV350U15C/C2	350A	●	●
2XLPV350U15D/DC		●	●
2XLPV400U15C/C2	400A	●	●
2XLPV400U15D/DC		●	●

C- 触刀安装带中央指示器 blade contacts with the center indicator
 C2- 触刀安装带中央指示器和顶部指示器 blade contacts the central indicator and The top of the indicator
 D- 螺栓连接 bolted connections
 DC- 螺栓连接带微动开关底座 bolted connections with microswitch base
 C、C2-Optional 可选择
 D、DC -Optional 可选择

U15 DENOTES FOR 1500V DC

U15 表示 1500V DC

● DENOTES FOR APPROVAL

● 表示已取得安全认证

○ DENOTES FOR PENDING

○ 表示正在申请安全认证

可选配件 Optional Accessory

目录编号 PART NO.	熔断器座 Fuse Holders	微动开关 Microswitches
2XLPVXXXU15C	NH3LBU15	/
2XLPVXXXU15C2	NH3LBU15	HMT-01
2XLPVXXXU15DC	/	HMC-01

NH2XLPV-C(D) 平均 I-T 曲线图 (仅供参考)

NH2XLPV-C(D) AVERAGE I-T CHARACTERISTICS CURVE (FOR REFERENCE)

